

LULA Specifications

Model & Type X3 (direct hydraulic)
 X5 (roped hydraulic)
 Capacity 1400#
 Code ASME A17.1 - LULA
 Speed 28 FPM
 Travel 25' maximum
 Platform 42" x 60"
 Hatch 57" x 69"
 Pit 36" / 12" with optional travel restrictor
 Overhead 11' / 9' with optional travel restrictor
 Landings 5 maximum
 Car Openings 1 or 2
 Door Size 36" x 80"
 Door Type Two speed side slide
 Operation Single button automatic with
 cartop inspection
 Power Supply 208 volt , 1 phase, 30 amp

CAB

Wall Finish Laminate
 Gate Type Two speed side slide
 Ceiling Finish Laminate
 Height 86"
 Handrails 1
 Floor Covering By Others

FIXTURES

COP 1
 Hall station 1 per landing
 Tel cabinet Optional
 Emergency light Optional
 Finish Stainless Steel

CONTROL

Controller Logic Microprocessor
 Control Voltage 24 volt
 Landing System Magnetic
 Pump Submersible Screw
 Valve 1speed with start acceleration
 and stop damping
 Battery lowering Optional
 Door Equipment GAL
 Gate operation Automatic
 Door operation Automatic

These specifications represent our standard LULA elevator unit. If any of these specifications must be modified to suit your requirements, please contact us to discuss your special requirements.

Elevator Concepts LTD continually improves its products. This specification is subject to change at the sole discretion of Elevator Concepts.

Drawings

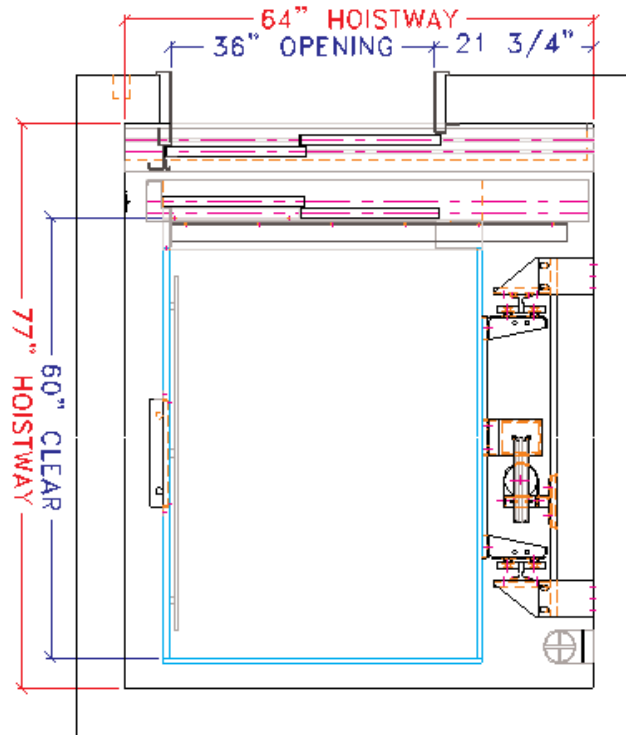

Note: Typical drawing for illustration only. Do not construct hoistway from this drawing. Consult the factory or your dealer.

Installation must be done in accordance with manufacturer's published installation and operation instructions as furnished with equipment, and in compliance with requirements of all applicable codes. Elevator Concepts LTD assumes no liability for equipment improperly installed.

ELEVATOR CONCEPTS LTD

Revised 4/02

Limit Use Limit Access Elevators

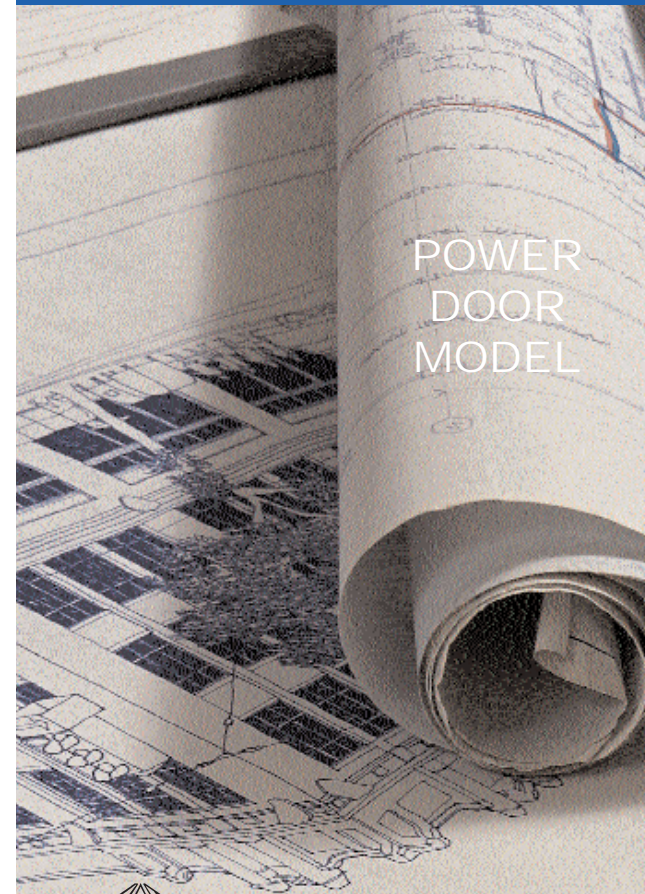

ELEVATOR CONCEPTS LTD

18720 Krause
 Riverview, MI 48192
 734-246-4700 (phone)
 734-246-2547 (fax)
www.elevatorconcepts.com

LULA Elevators

Barrier-Free Access

Accessibility is a concern for everyone. With new laws mandating barrier-free access, there is a growing public demand for vertical transportation for the disabled. The TIGER LIFT® series offer an practical and affordable solution to overcoming these barrier-free concerns.

Our TIGER LIFT® limited use / limited access (LULA) configuration complies with ASME A17.1 Elevator Code. The low cost and compact design of this elevator make them the ideal solution to vertical transportation issues for churches, office buildings, schools and private organizations.

All TIGER LIFT® LULA models incorporate our advanced frame design and allow for a diverse array of configuration options. Making it the perfect choice for existing buildings by keeping structural and electrical modifications to a minimum, while providing a quiet operation and superior ride quality.

Power Door Operation

Elevator Concept offers a LULA elevator with power doors. The optional power operator features a smooth, quiet linear screw drive and magnetic link provides safe and dependable automatic gate operation.

Technology, Reliability, Quality



Since 1986 Elevator Concepts has designed and manufactured high quality TIGER LIFT® elevators specifically for the residential and access market.

All TIGER LIFT® elevators combine the latest technology with value, quality and reliability, with innovations like vacuum stress skin cabs and Hall effect electronic switches. Every TIGER LIFT® is backed by superior customer service, technical support, and an one year limited warranty.

Warranty

Your investment with Elevator Concepts is protected with a one year limited warranty against defects in material or workmanship.

For more information on the products we manufacturer or pricing, please contact a Sales Representative today at (734) 246-4700 or visit us on the web.



Oak laminate interior with woodfold gate

Standard Features

- GAL Door Equipment
- Cartop Inspection Operation
- 42" x 60" Car Size
- 1400 Pound Capacity
- 28 FPM
- Microprocessor Control
- Single Speed Valve

Safety

- Complies with ASME A17.1
- Handrail, alarm button, emergency stop button and emergency light
- Leveling/anticreep operation
- Car safety with safety switch and rupture valve on roped hydraulic models

Options

- Battery Lowering
- 2 speed valve
- Top and bottom travel restrictors
- ADA phone
- Custom cab finishes
- Overspeed governor

YOUR DEALER IS:

Visit us on the web @ www.elevatorconcepts.com